

AC Curtain Motor- DT52EN Specification

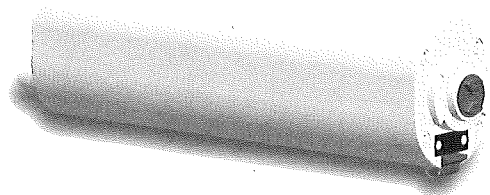

(A-01)

Product introduction

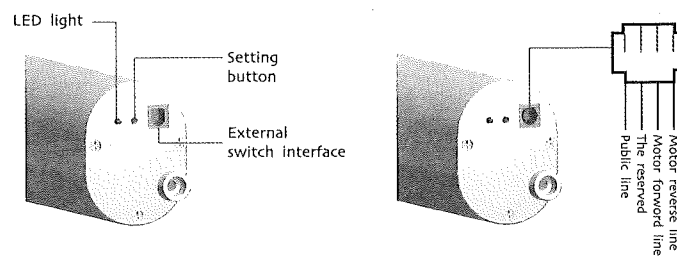

Functional features

- Electronic limit
- Limit memorized after power off
- Touch-start
- The third limit position
- Resistance and stop function
- external switch control
- Set and delete limit
- Manual adjustment limit

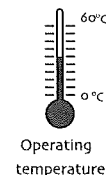

Parameter (More models and parameters are subject to the nameplate)

Type	DT52EN
Rated Torque(N.m)	0.8N.m
Open / Close Speed(cm/s)	20cm/s
Rated Voltage(V)	230V
Emission Frequency(MHz)	433.925MHz

Motor installation

- The joint assembly of track**
 - Insert the track joint board into the two ends of track.
 - Insert the track joint bracket for one end to the track joint.
 - Fix the screws.

Note: The track needs to be engraved when the length is less than required. The track needs to be engraved when inconvenient to transport.
- The assembly of rubber belt for curtain motor**
 - The confirmation of profiled material dimension**
The length of profiled material = The total length of track - 14.8cm
For example: the total length of the track is 2m.
The length of profiled material: 200cm - 14.8cm = 185.2cm
 - The confirmation of rubber belt dimension**
S track: The length of the rubber belt = (The total length of track X 2) - 4.5cm
A track: The length of the rubber belt = (The total length of track X 2) - 5.5cm
The length of the rubber belt (S track): (200cm X 2) - 4.5cm = 395.5cm
Note: Please cut through the middle of gear apex.
 - The assembly of rubber belt fastening button**
Please leave half gear at both ends when assemble rubber belt fastening button.
- Please leave one gear at middle of two rubber belt fastening button when assemble rubber belt fastening button at the middle of rubber belt**
- Fold the rubber belt and assemble the rubber belt fastening button into the master carrier over lap arm**
Before installation, please be sure to confirm the purchase of the products is new or old products. The following installation for hook is for new products, if you buy the old products, please assemble the hooks after finishing the step 9!
- Please the profiled material in as the picture showed**
- Open the rubber belt button at this end**
- The place the rubber belt button into the master carrier over lap arm as the picture showed**
- Place the master carrier over lap into the fastening button as the arrow indicates, then place into the profiled material**
- Place the upper covers into the both sides of the track**
- Place the leather belt and gears into the upper covers**
- Place the lower cover into the upper cover and lock the by screws**
- Cover the upper and lower cover by upper and lower coverboard**
- Place the runners into the track respectively**
- Place the connection parts into the lower cover and asten them by screwdriver**

3 Folding method for joint track (for easy transit)

- Track folding method**
 - Search for the slip part connected with the ends of the rubber belt.
 - Take off the screw of the slip parts and the connection bracket.
 - Push the connection parts to one side.
 - Pull the slip parts slightly and separate the connection part at the same time.
 - Fold the track.

Restoring the track

- Unfold the folded track.
- Combine the track slowly.
- Push the connection bracket to the connection part.
- Screw the connection bracket and install the slip parts.
- The track is successfully assembled.

4 The installation for curtain motor and cable

- Check the position of brackets, fix it at an appropriate place on the track.
- Assemble the curtain motor track at appropriate place, then fix with screws.
- Assemble the motor.
- Please check assembling is ok.
- Finish assembling.

Wiring diagram:
220V/230V: Yellow / green line = Earth, Brown line = Live, Blue line = Neutral.
120V: Green line = Earth, Black line = Live, White line = Neutral.

5 Weak electric Switch connection method of curtain motor

(The specific operation on the back as shown in the <weak electric switch mode selection> action bar)

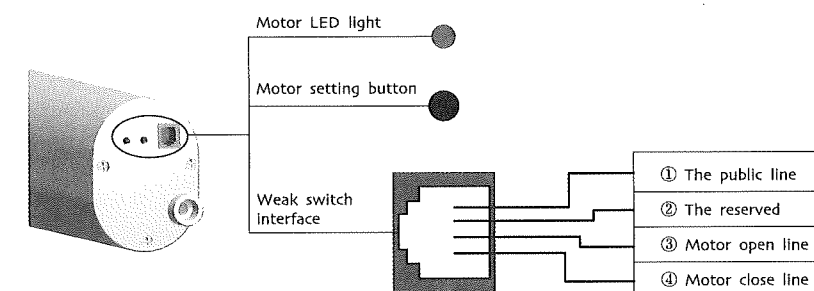

- Double-button refundable switch mode: ①+③ → Control motor open or stop; ①+④ → Control motor close or stop.
- Double-button can not rebound switch mode: ①+③ → Control motor open or stop; ①+④ → Control motor close or stop.
- DC246 switch mode: ①+③ → Control motor open; ①+④ → Control motor close; ①+③+④ → Control motor stop.
- Single-button cyclic switch mode: ①+③ → Control motor open-motor close-motor stop.

Operating considerations

Before operation, please read the following precautions:

- Operating:**
 - The valid interval of the emitter button is 10s, the emitter will quit the set after 10s.
 - The LED flashes, please do the next step after the hint.
- Set limit position:**
 - Every time you install the motor, first set after a curtain opened travel to work properly;
 - After setting, with power and memory function, after each power cycle required to open or close a recovery stroke;
 - After replacing the track or cord to be removed for the trip, and then set itinerary.
- When the motor running without any operation, the maximum running time is 6 minutes, it will stop automatically.
- If the emitter lost, please set up again with new emitter.



Button specification

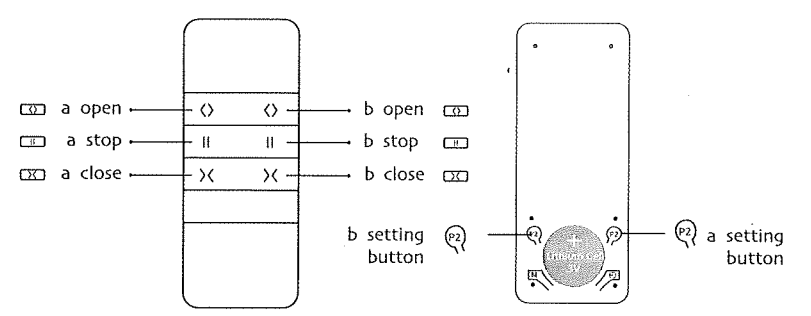

Note: the following instructions all take the "a" as an example.

1 Setting up

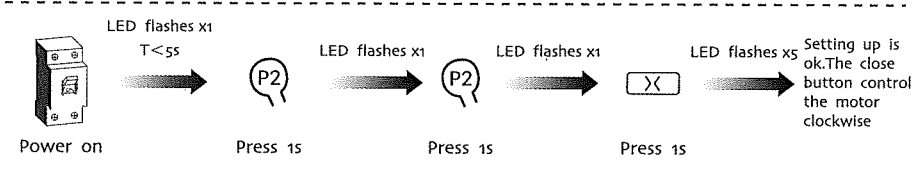
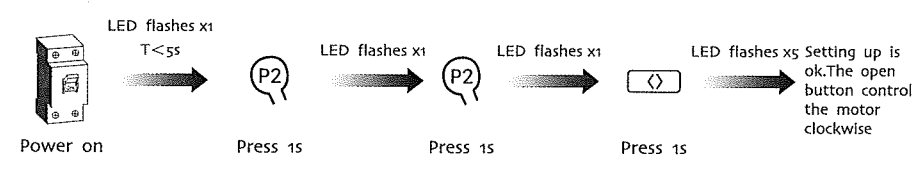

Note: Motor has been matched the code, don't use this method; Press the open button, if the curtain closed, please perform the reverse of direction setting.

2 The reverse of direction setting

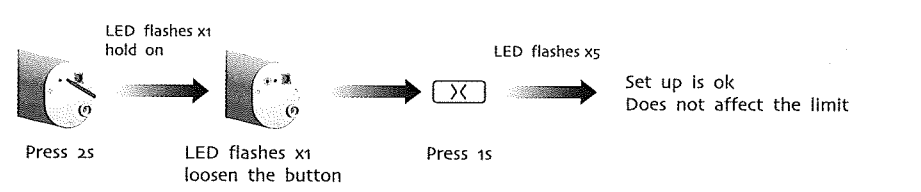

3 Add emitter

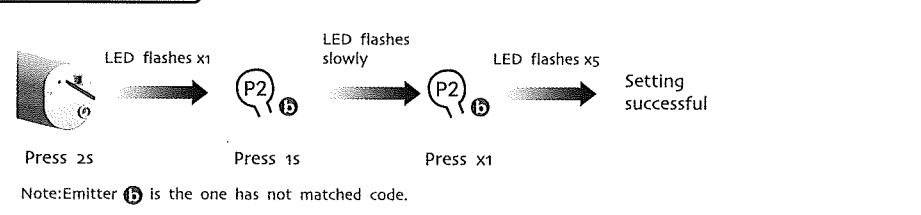

4 Touch-start

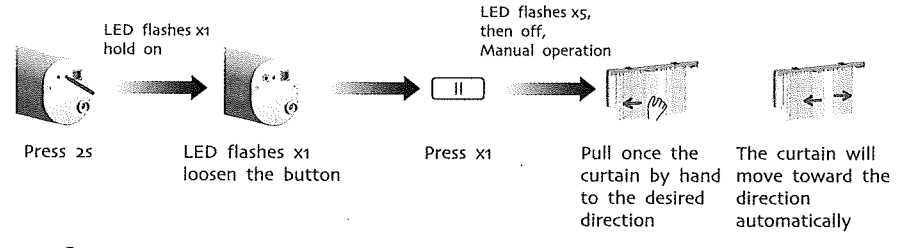

Note: ① When operate the curtain by hand, never force to pull the curtain, which will damage the track and the fabric; ② If need to close manual function, please repeat above operation; ③ Manual operation is default.

5 Set limit position

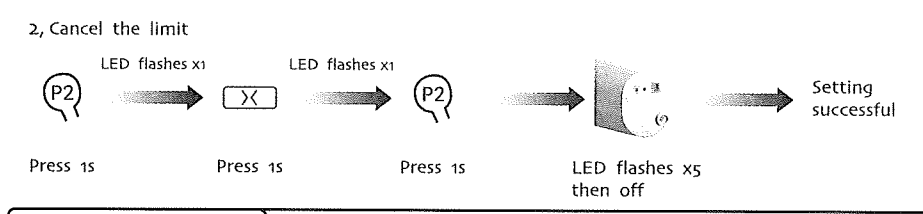
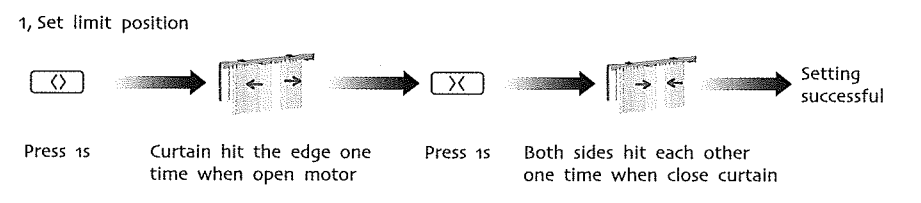

6 Manually set limit

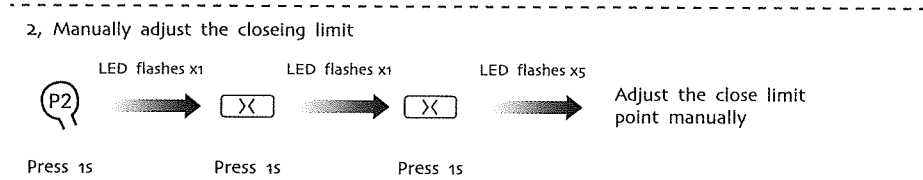
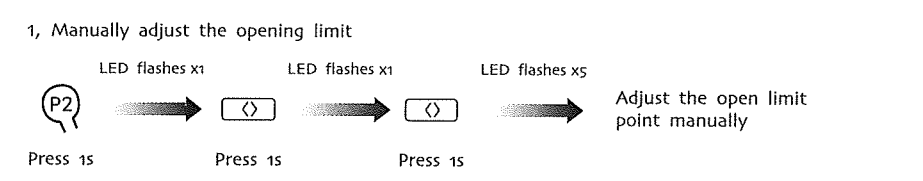

Note: The manual set limit should be with in the range of the the auto-set limit . If the manual set limit is faulty , you can repeat the setting procedure to delete it,then reset.

7 The third limit setting

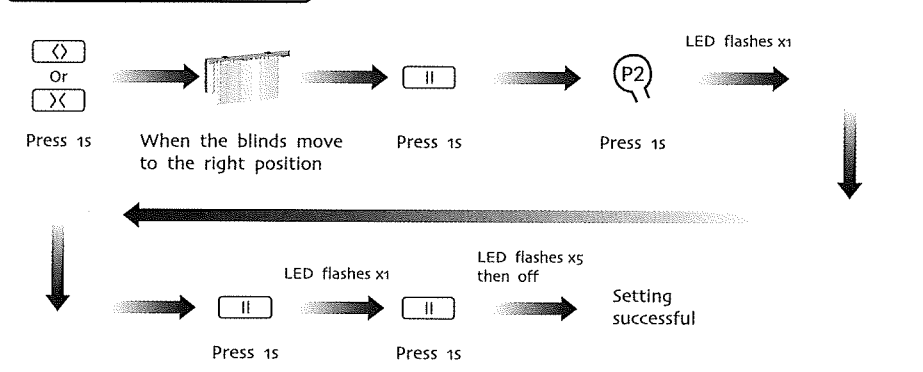

8 Weak Electric Switch Mode Selection

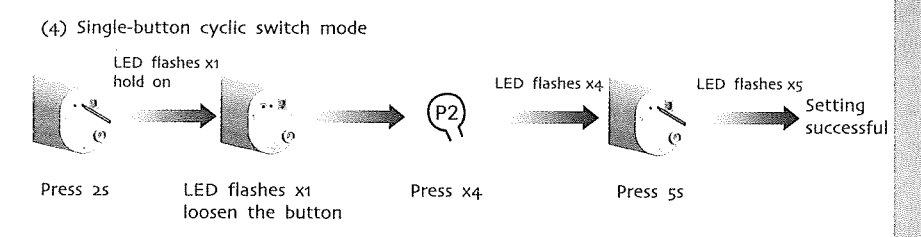
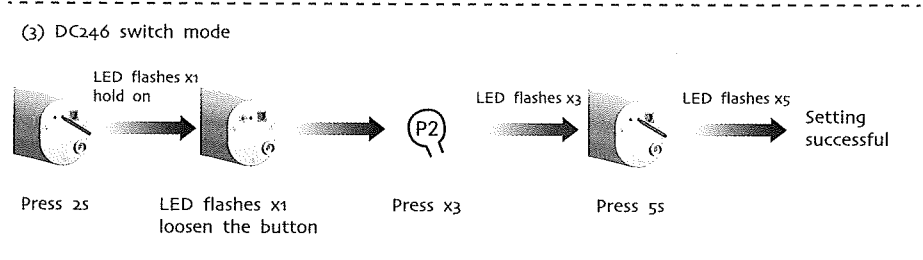
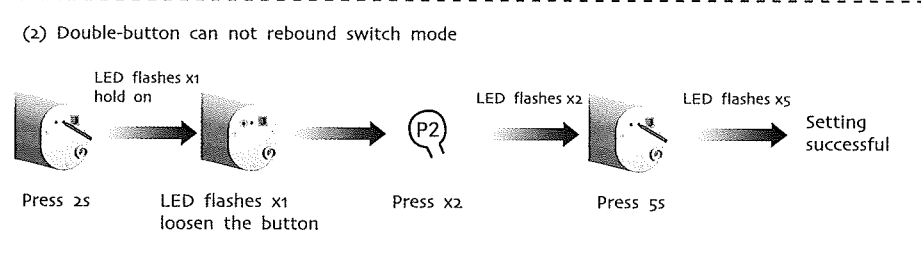
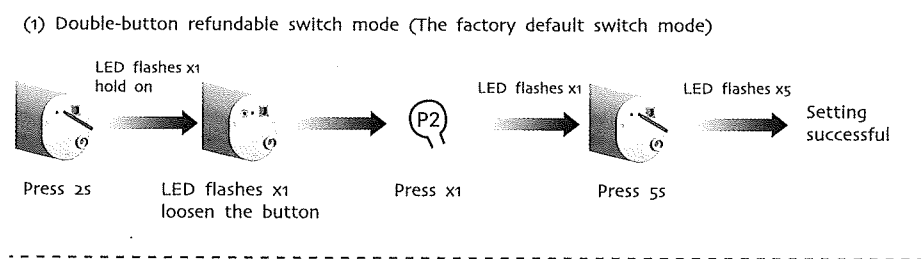

9 Restore factory settings

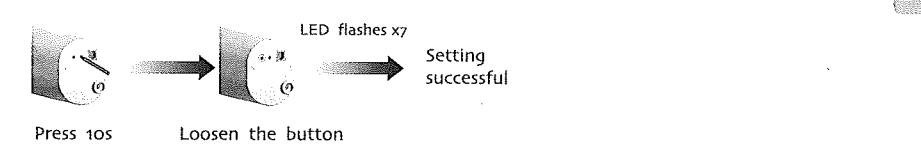

FAULT AND SOLUTION

NUMBER	COMMON FAULTS	CAUSE ANALYSIS AND TREATMENT METHOD
1	The motor is not running	Check whether the batteries are charged
2	Unable to control remote controller	Replace emitter
3	Remote control on the contrary	Replacement the reverse of direction setting
4	Remote switch on the contrary	Replacement switches line order
5	Cannot close	1, Check emitter's open button to ensure if it works with open function, if not, please change direction firstly; 2, Check limit position;
6	Always hit or couldn't get to the edge	Cancel the limit, setting again
7	With the hand to pull, feeling stuck	Set the limit of the trip
8	Encounter obstacles will not stop	Check the screw used to fixed orbital